

1

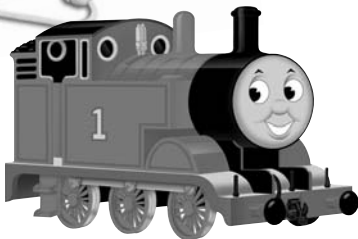

calling All Engines Phone

User's Manual



Dear Parent,

*At VTech® we know that a child's imagination is a truly wonderful thing and needs to be developed and nurtured. That's why we created the **Thomas & Friends™** learning series of interactive learning toys to stimulate children's imaginations, while also teaching vital preschool concepts such as the letters, numbers, phonics, counting, vocabulary and music.*

*Through the use of unique technology and engaging child-directed role-play scenarios, **Thomas & Friends** characters magically come to life to guide children through learning activities. These engaging characters foster children's critical reasoning skills, enhance their fine motor skills and engage them in exciting role-play activities for endless hours of learning fun.*

At VTech® we know that a child has the ability to do great things. That's why all of our electronic learning products are uniquely designed to develop a child's mind and allow them to learn to the best of their ability. We thank you for trusting VTech® with the important job of helping your child learn and grow!

Sincerely,

Your Friends at VTech®

Other VTech® toys, visit www.vtech.com.

*To learn more about **Thomas & Friends** visit www.thomasandfriends.com*

INTRODUCTION

Thank you for purchasing the **VTech® Thomas & Friends: Calling All Engines Phone**.

The **VTech® Thomas & Friends: Calling All Engines Phone** is an interactive phone that's full of fun! The light-up easy to press buttons help to develop motor skills. With three fun-filled modes of play to explore, your child will develop basic knowledge and memory skills while playing along with Thomas and his friends.

Special
Thomas
"Suprise"
Button

Handset

On/Off
Button

3 Mode
Buttons

Phone
Cord



Engine
Whistle
Button

Engineer
Button

Repeat
Button

10 Light-up
Number/
Character
Buttons

INCLUDED IN THIS PACKAGE

- One **VTech® Thomas & Friends: Calling All Engines Phone**
- One instruction manual

WARNING:

All packing materials such as tape, plastic sheets, wire ties and tags are not part of this toy, and should be discarded for your child's safety.

GETTING STARTED

BATTERY INSTALLATION

1. Make sure the unit is Off.
2. Locate the battery cover at the bottom of the unit. Use a coin or screwdriver to loosen the screw.
3. Install 3 new "AA" (UM-3/LR06) batteries as illustrated. (The use of new, alkaline batteries is recommended for maximum performance.)
4. Replace the battery cover and tighten the screw to secure the battery cover.

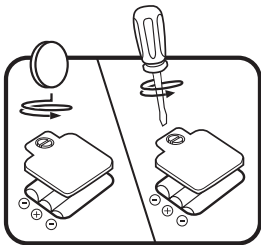

BATTERY NOTICE

- Non-rechargeable batteries are not to be recharged.
- Rechargeable batteries are to be removed from the toy before being charged (if removable).
- Rechargeable batteries are only to be charged under adult supervision (if removable).
- Different types of batteries or new and used batteries are not to be mixed.
- Only batteries of the same or equivalent type as recommended are to be used.
- Batteries are to be inserted with the correct polarity.

- Exhausted batteries are to be removed from the toy.
- The supply terminals are not to be short-circuited.
- The toy is not to be connected to more than recommended number of power supplies.
- Do not dispose of battery in fire.

WE DO NOT RECOMMEND THE USE OF RECHARGEABLE BATTERIES.

PRODUCT FEATURES

ON/OFF BUTTON

1. To begin play, press the **On/Off** () button. The Narrator will greet you and guide you to explore in the free-play mode.
2. Choose a mode to play at any time by pressing one of the three Mode Selection Buttons on Thomas' wheels.



3. Press the **On/Off** button again to turn the unit off.

HANDSET

When you pick up or put down the handset, the voice of the Narrator will be heard.



THOMAS "SURPRISE" BUTTON

Press the Thomas "Surprise" Button and hear a song while watching a fun light pattern play on the buttons. Press the button again and hear a different song!

ENGINE WHISTLE BUTTON



Press the Engine Whistle Button and enjoy two different whistle sounds.

ENGINEER BUTTON



Press the Engineer Button to hear fun phrases and sound effects.

REPEAT BUTTON

Repeat

Press the Repeat Button while playing a game to hear the question again or get a clue to the answer.

Character/Number Buttons

Press these buttons to answer questions during the different modes of play, or explore on your own during free play mode.

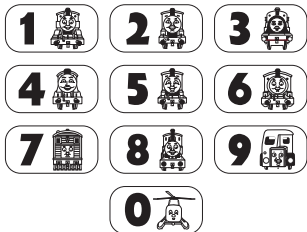

number 1 button: Thomas

number 2 button: Edward

number 3 button: Emily

number 4 button: Gordon

number 5 button: James

number 6 button: Percy

number 7 button: Toby

number 8 button: Duncan

number 9 button: Bertie

number 0 button: Harold

AUTOMATIC SHUT-OFF

To preserve battery life, the **VTech® Thomas & Friends: Calling All Engines Phone** will automatically turn off after several minutes without input. The unit can be turned on again by pressing the **On/Off** button.

ACTIVITIES



Find & Learn

Select the **Find & Learn** mode by pressing this button.

The Narrator will ask you to find his friends or ask who is above/below, or to the left/right of a certain friend. Answer by pressing the correct Character Button. If you do not find the correct answer, after three tries, the light-up button will flash the correct answer.



Call Our Friends

Select the **Call Our Friends** mode by pressing this button.

In this activity, the Narrator will ask you to help him call his friends or dial a specific number. Answer by pressing the correct Number/Character Button. If you do not find the correct answer, after three tries, the light-up button will flash the correct answer.



Follow the Lights

Select the **Follow the Lights** mode by pressing this button.

Three lights will light up in a sequence. You need to watch the lights carefully and press the buttons in the same order. If you get it correct, Thomas will add another light to the sequence which you then need to remember and repeat. See how many you can remember!

CARE & MAINTENANCE

1. Keep the unit clean by wiping it with a slightly damp cloth.
2. Keep the unit out of direct sunlight and away from any direct heat source.
3. Remove the batteries when the unit is not in use for an extended period of time.
4. Do not drop the unit on hard surfaces and do not expose the unit to moisture or water.

TROUBLESHOOTING

1. If your **VTech® Thomas & Friends: Calling All Engines Phone** stops working or does not turn on:
 - Check your batteries. Make sure the batteries are fresh and properly installed.
 - If you are still having problems, visit our website at www.vtechkids.com for troubleshooting tips.
2. If, when pressing the On/Off button, nothing happens:
 - Check to see that the batteries are aligned correctly

TECHNICAL SUPPORT

If you have a problem that cannot be solved by using this manual, we encourage you to visit us online or contact our Consumer Services Department with any problems and/or suggestions that you might have. A support representative will be happy to assist you.

Before requesting support, please be ready to provide or include the information below:

- The name of your product or model number (the model number is typically located on the back or bottom of your product).

- The actual error message or problem you are experiencing.
- The actions you took right before the error message or problem occurred.

Internet: www.vtechkids.com

Phone: 1-800-521-2010 in the U.S. or 1-877-352-8697 in Canada

OTHER INFO

VTech® Electronics North America, L.L.C. and its suppliers assume no responsibility for any damage or loss resulting from the use of this handbook. VTech® Electronics North America, L.L.C. and its suppliers assume no responsibility for any loss or claims by third parties that may arise through the use of this software. VTech® Electronics North America, L.L.C. and its suppliers assume no responsibility for any damage or loss caused by deletion of data as a result of malfunction, dead battery, or repairs. Be sure to make backup copies of important data on other media to protect against data loss.

COMPANY : VTech® Electronics North America, L.L.C.

ADDRESS : 1155 W. Dundee Road, Suite 130, Arlington Heights, IL 60004, USA

TEL NO.: (847) 400-3600

NOTE: This equipment has been tested and found to comply with the limits for a Class B digital device, pursuant to Part 15 of the FCC Rules. These limits are designed to provide reasonable protection against harmful interference in a residential installation. This equipment generates, uses and can radiate radio frequency energy and, if not installed and used in accordance with the instructions, may cause harmful interference to radio communications. However, there is no guarantee that interference will not occur in a particular installation. If this equipment does cause harmful interference to radio or television reception, which can be determined by turning the equipment off and on, the user is encouraged to try to correct the interference by one or more of the following measures:

- Reorient or relocate the receiving antenna.
- Increase the separation between the equipment and receiver.
- Connect the equipment into an outlet on a circuit different from that to which the receiver is connected.
- Consult the dealer or an experienced radio/TV technician for help.

Caution: Changes or modifications not expressly approved by the party responsible for compliance could void the user's authority to operate the equipment.

IMPORTANT NOTE:

Creating and developing **VTech® Thomas & Friends: Calling All Engines Phone** products is accompanied by a responsibility that we at **VTech®** take very seriously. We make every effort to ensure the accuracy of the information which forms the value of our products. However, errors sometimes can occur. It is important for you to know that we stand behind our products and encourage you to call our Consumer Services Department at 1-800-521-2010 in the U.S. or 1-877-352-8697 in Canada with any problems and/or suggestions that you might have. A service representative will be happy to help you.

Thomas the Tank Engine & Friends™

CREATED BY BRIT[®] ALLCROFT

Based on The Railway Series by The Reverend W Awdry. © 2006 Gullane (Thomas) Limited.

Thomas the Tank Engine & Friends and

Thomas & Friends are trademarks of Gullane (Thomas) Limited.

Thomas the Tank Engine & Friends & Design is Reg. U.S. Pat. & Tm. Off.



©2006 VTech

Printed in China

91-02199-000(美)